

## Gas Detector

# Sigma ReAct

Product code: PW-093-SR-X



**Reliability**



**Innovations**



**A wide range of electrochemical sensors**

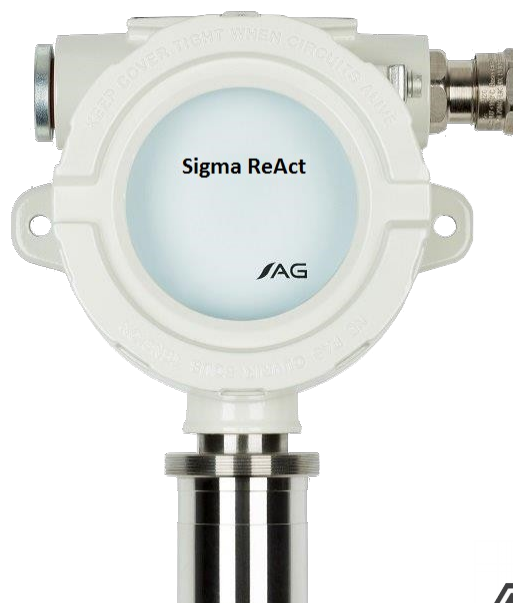

## Information about the product

Gas Detector **Sigma ReAct** is stationary devices, designed to measure, monitor and detect dangerous level of reactive gases in the ambient atmosphere - depending on the gas for which it is intended, the manufacturer selects the type of electrochemical sensor. The device measures the concentration of a given component, and then converts it to electric signal compatible with other devices of the gas detection system. In addition to the measurement, the detector analyses the value of the measured concentration and may provide information about alarms. **Sigma ReAct** is a selfdiagnostic device – and in the case of detection of malfunctions, it informs the user about it.

## Location and role of the device in Gas Safety System

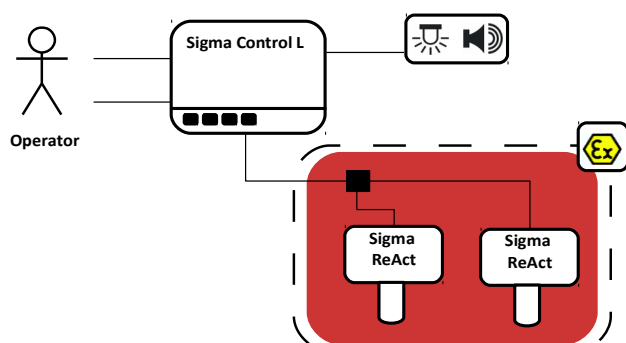

## Electrical interface

B	A	+	-
---	---	---	---

Pin	Description
B	Signal line B
A	Signal line A
+	Positive
-	Negative

## Dimension

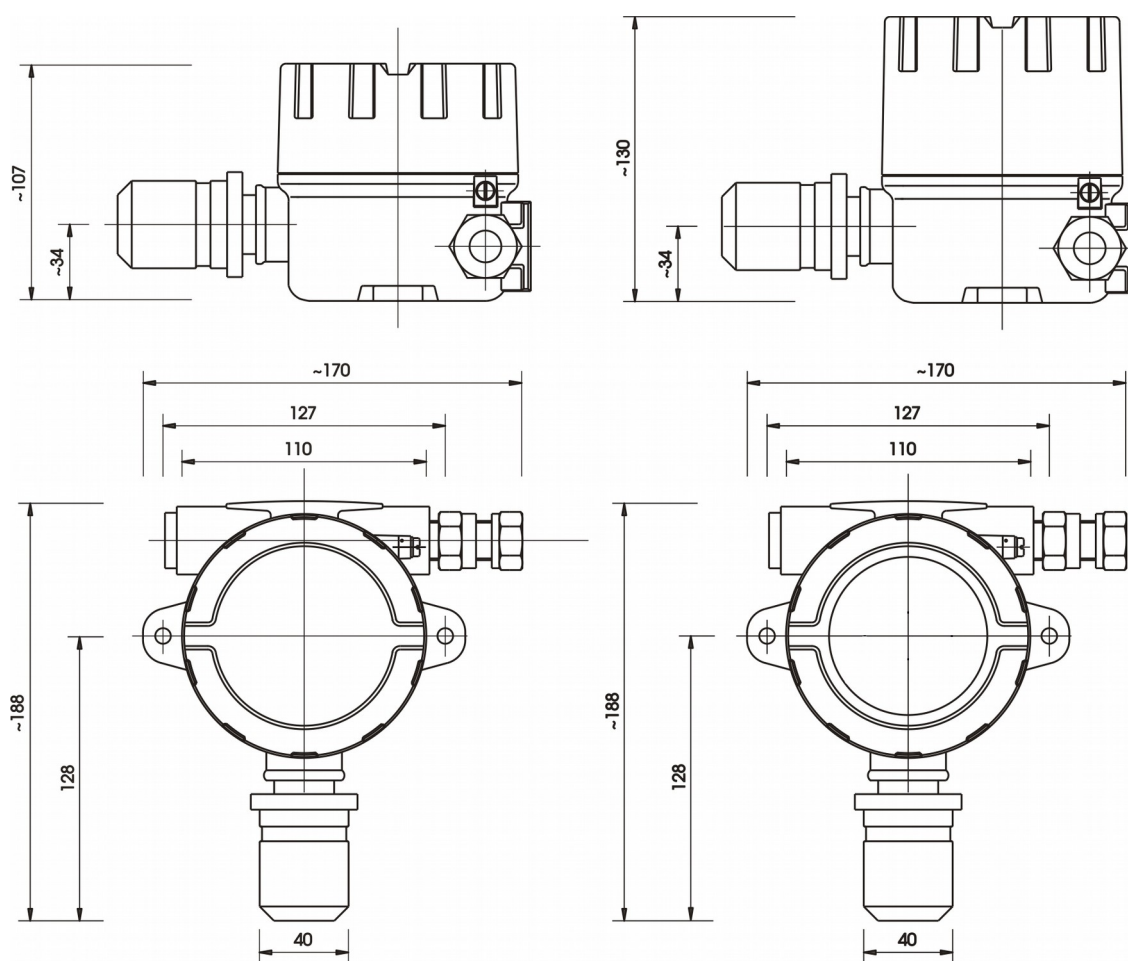

Without display	With a display
-----------------	----------------

## Technical specification

<b>Power supply</b> <ul style="list-style-type: none"><li>• Voltage Vcc</li><li>• Power</li></ul> <b>Environment</b> <ul style="list-style-type: none"><li>• Ambient temperatures</li><li>• Humidity</li><li>• Pressure</li></ul>	12 – 30 V 0,4 – 2,2 W  -40 – +50 °C 10 – 90% long term 0 – 99% short term without condensation  1013 ± 10% hPa Any of the above parameters can be limited by the parameters of the sensor	
ATEX	 II 3G Ex nA IIC T3 Gc	-40 ≤ Ta ≤ 50°C
IP	Safe conditions of the device work and uninterrupted access of gas to the sensor	Safe conditions of the device work and potential interrupted access of gas to the sensor
	IP 63	IP 64

<b>Digital communication parameters</b> <ul style="list-style-type: none"><li>• Port<ul style="list-style-type: none"><li>• Electric standard</li><li>• Communication protocol</li></ul></li></ul>	RS - 485 Sigma Bus
<b>Integrated signalling equipment (visual)</b>	Bright, four-colour status display
<b>Cable glands</b> <ul style="list-style-type: none"><li>• cable diameter range</li><li>• external thread</li></ul>	3,2 – 8 mm, 6,5 – 11,9 mm, 10,0 – 14,3 mm M20
<b>Enclosure material</b>	<ul style="list-style-type: none"><li>• Aluminium spray epoxy / SS316L / PTFE (option E = Alx)</li><li>• Aluminium creodur epoxy / SS316L (option E = C)</li><li>• SS316L (option E = SS)</li></ul>
<b>Weight</b>	3,5 kg
<b>Mandatory periodic inspection</b>	Every 12 months (Calibration Certificate validity) – the time can be shortened because of the difficult working conditions
<ul style="list-style-type: none"><li>• Mounting</li></ul>	<ul style="list-style-type: none"><li>• To wall 2 holes for the pin with diameter 4 mm, hole spacing 127 mm</li><li>• By Mounting Adapter: PW-064-WM1 / PW-064-WM2 / PW-064-WM4 / PW-064-WM6</li></ul>

## Product marking

Product code	Device
PW-093-SR-X	Gas Detector Sigma ReAct



**Atest Gaz A. M. Pachole sp. j.**  
ul. Spokojna 3, 44-109 Gliwice

tel.: +48 32 238 87 94  
fax: +48 32 234 92 71  
e-mail: [contact@atestgaz.pl](mailto:contact@atestgaz.pl)

For more details on our devices and other products and services offered by us, visit:

**[www.atestgaz.pl/en](http://www.atestgaz.pl/en)**

**Legal Notice:**

This document is not an offer in the meaning of the civil code and other relevant regulations, but merely constitutes an invitation to conclude an agreement pursuant to article 71 of the Polish Civil Code. Atest-Gaz A. M. Pachole sp. j. stipulates the right to unilaterally change and modify the present document at any time as well as to introduce changes related to the product characteristics. Products parameters can be changed without any prior notice.