

User Manual



Service Cable

CB6

Product code: PW-049-CB6

Remarks and reservations

- Read and understand this manual prior to connection and operation of the device. Keep the User Manual with the device for future reference.
- The manufacturer shall not be held responsible for any errors, damage or defects caused by improper selection of suitable devices or cables, errors in installation of equipment or any misuse due to failure to understand the document content.
- Unauthorised repairs and modifications of the device are not allowed. The manufacturer shall discard any responsibility for consequences of such actions.
- Exposure of the device to the impact of excessive mechanical, electric or environmental factors may lead to damage of the device.
- Operation of damaged or incomplete devices is not allowed.
- Engineering of a gas safety system for any specific facilities to be safeguarded may need consideration of other requirements during the entire lifetime of the product.

How to use this manual?

Important fragments of the text are highlighted in the following way:



Pay extreme attention to information provided in such framed boxes.

1. Preliminary information

Service Cable CB6 is used to connect Sigma Gas with computer or another device with serial USB communication port. It provides a hardware interface between the Sigma MOD DRV and the service device. This connection together with the appropriate software installed in the service device allows you to:

- calibrate the gas detectors,
- parametrized the system,
- other service operation.

Service Cable CB6 can also be used to connect directly to Sigma detector. In this case use the cable package included in the kit (gas detector requires a power connection).



The device is designed only for work with a service terminal in the Control Unit Module Sigma MOD DRV or Sigma detector. Do not use the cable with other interfaces.

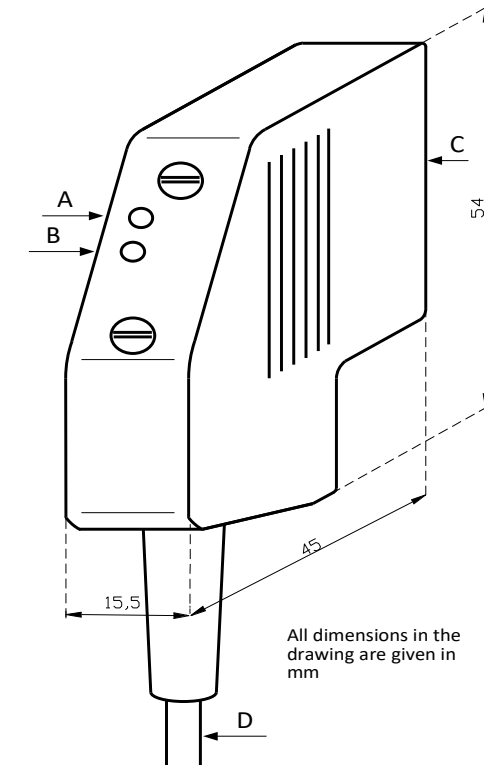

All dimensions in the drawing are given in mm

Figure 1: Service Cable CB6 – the construction and connection

2. Input-output interfaces, connection

The device has two connection ports (see figure 1):

- USB port (D) – designed for connection with computer. The use of the service cable does not require the drivers installation. After the devices recognized by the computer, the service cable is ready for use,
- Sigma BUS port (C) – designed for connection the Control Unit Module Sigma MOD DRV using „service socket” port or Sigma detector by the cable package included in the kit.

Service Cable CB6 provides galvanic isolation between the communication port of the computer (USB) and the Control Unit Module Sigma MOD DRV (RS485). The accurate parameters of strength of galvanic isolation can be found table 1.



Connecting and disconnecting the service cable should be done by holding the proper terminal. Do not pull on the cable.

3. User interface

The USB port terminal has 2 LED indicator (see figure 1):

- A** – it signals flow of information towards computer → Control Unit Module Sigma MOD DRV or Sigma detector,
- B** – it signals flow of information towards Control Unit Module Sigma MOD DRV or Sigma detector → computer.

4. Device start-up

After proper connection and configuration the device doesn't require any additional start-up process.

5. Utilization

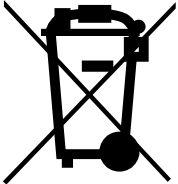

This symbol on a product or on its packaging indicates that the product must not be disposed of with other household waste. Instead, it is the user's responsibility to ensure disposal of waste equipment by handing it over to a designated collection point for the recycling of waste electrical and electronic equipment. The proper recycling of your waste equipment at the time of disposal will help to conserve natural resources and ensure that it is recycled in a manner that protects human health and the environment. Information about relevant designated collection points can be obtained from the Local Authority, waste disposal companies and in the place of purchase. The equipment can also be returned to the manufacturer.

6. Product marking

Product code	Device
PW-049-CB6	Service Cable CB6

7. Supported operating systems and software

Service Cable works with Sigma Toolbox under control of: Windows XP, Windows Vista, Windows 7, Windows 8, Windows 8.1 and Windows 10.

For proper operation with the Service Cable use the latest Sigma Toolbox revision.

8. Technical specification

Environment	
• Ambient temperatures (in operation/storage)	0 – +50 °C
• Humidity	10 – 90% long term, without condensation
IP	IP 20
Digital communication parameters	USB
• Black cable gland	RS-485, Sigma BUS
• Terminal in the enclosure	
Strength of galvanic isolation	600 V
Integrated signalling equipment (optical)	LED green indicators
Protection class	III
Terminal in the enclosure dimensions	See figure 1
The length of the wire	2.5 m
Enclosure material	Polyamide
Weight	0.15 kg

Table 1: Technical specification

9. Appendices

DEZG109-ENG – EU Declaration of Conformity – Service Cable CB6

UE Declaration of Conformity

Atest Gaz A. M. Pachole sp. j. declares with full responsibility, that the product:

(Product description)	(Trade name)	(Type identifier or Product code)
Service Cable	CB6	PW-049-CB6

complies with the following Directives and Standards:

- in relation to Directive 2014/30/EU – on the harmonisation of the laws of the Member States relating to electromagnetic compatibility:
 - EN 50270:2015
- in relation to directive 2011/65/EU – on the restriction of the use of certain hazardous substances in electrical and electronic equipment:
 - EN 50581:2012

This declaration of conformity is issued under the sole responsibility of the manufacturer.

Purpose and scope of use: product is intended for use in gas detection systems for residential, commercial and industrial environment.

This EU Declaration of Conformity becomes not valid in case of product change or rebuild without manufacturer's permission.

Gliwice, 7.06.2019



(Nazwisko i Podpis)

Managing Director
Aleksander Pachole

Atest Gaz A. M. Pachole sp. j.
ul. Spokojna 3, 44-109 Gliwice



tel.: +48 32 238 87 94
fax: +48 32 234 92 71
e-mail: contact@atestgaz.pl

www.atestgaz.pl